

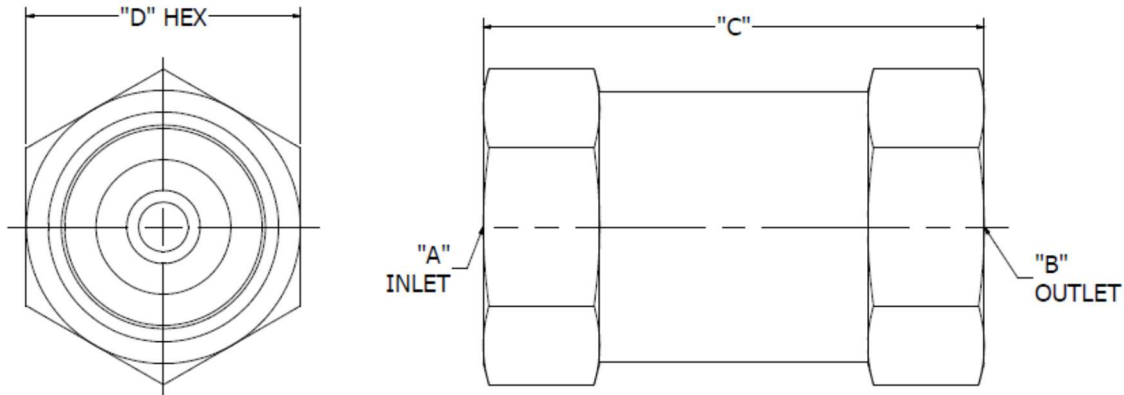

Flow Regulator Valve Model: FR-Series



Max Operating Pressure: 200 psig

Max Operating Temperature: 250°F

Recommended Operating Temperature: <180°F

Available Flow Capacities: 0.13 to 30 GPM (Flow rates are maintained to within +/-15% up to a pressure drop of 125 psi.)

Connection Sizes: 3/8" to 1" (-6 to -16)

Connection Type: NPT

Materials of Construction:

Body: Nickel Plated Brass

Flow Orifice: Buna-N

MODEL	"A" (NPT)	"B" (NPT)	"C" (in)	"D" (in)	Threshold psi	Available Flow Rates GPM +/- 15%
FR38MF	3/8" Male	3/8" Female	1.60	7/8	15-25	0.13, 0.25, 0.35, 0.50, 0.75, 1.0, 1.5
FR38FF	3/8" Female	3/8" Female	1.75	7/8	15-25	0.13, 0.25, 0.35, 0.50, 0.75, 1.0, 1.5
FR12FF	1/2" Female	1/2" Female	1.95	1	15-25	1.0, 1.5, 2.0
FR34FF	3/4" Female	3/4" Female	2.29	1-1/4	15-25	3.0, 3.5, 4.0, 5.0, 6.0, 7.0, 8.0, 9.0, 10
FR1FF	1" Female	1" Female	2.75	1-1/2	15-25	3.0, 3.5, 4.0, 5.0, 6.0, 7.0, 8.0, 9.0, 10, 15, 20, 30



Flow Characteristics

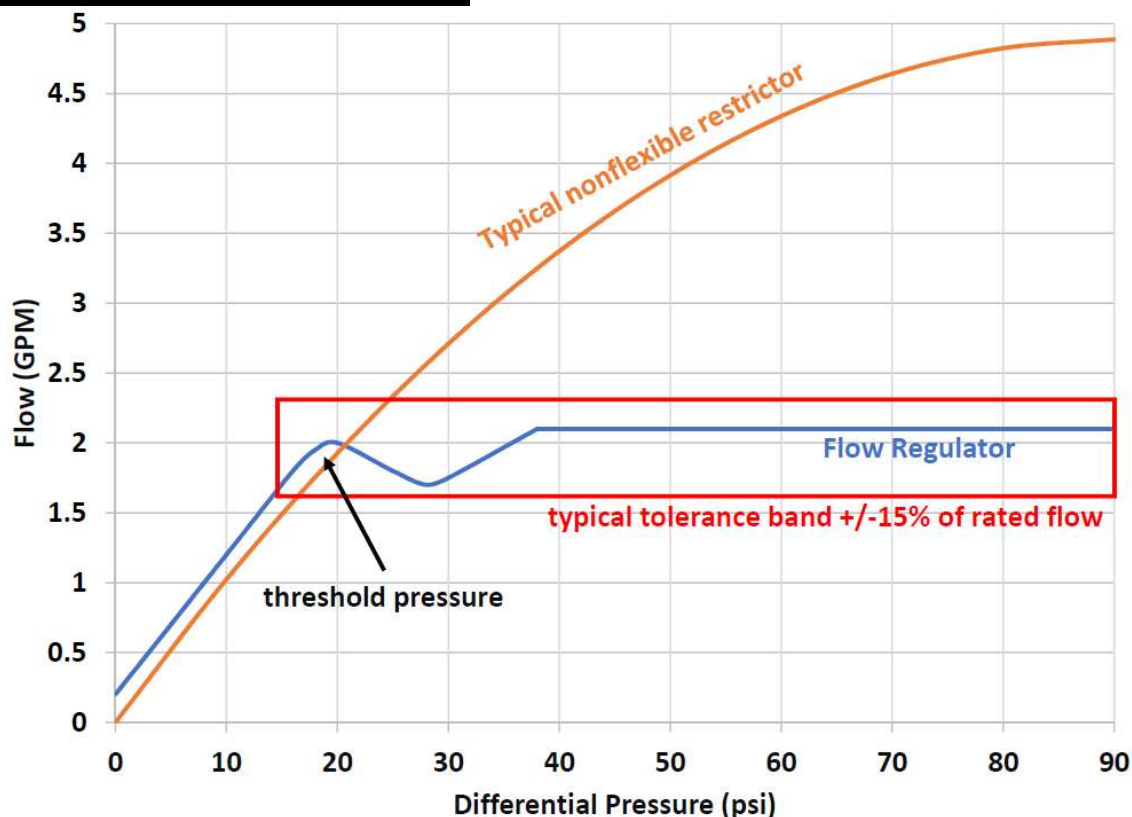

*Typical flow curve of FR12 at 2 GPM.

Ordering Information

FR	12	FF	-	NP	-	1.5
Connection Size		Connection Type (See Table Above)		Plating Option		Flow Rate (See Table Above)
		Option	Code	Option	Code	
		Male x Female	MF	None	(Blank)	
		Female x Female	FF	Nickel Plated	NP	

Options

1. Inlet Connection Size: The available sizes are 1/4" to 1-1/2".
2. Connection Type
 - a. Male x Female- Male NPT inlet and female NPT outlet connection (Only available for FR38).
 - b. Female x Female- Female NPT inlet and female NPT outlet connection.
3. Plating Option
 - a. None
 - b. Nickel Plated – Electroless Nickel Plated Brass
4. Flow Rate
 - a. Available Flow Rates for each size is listed in the table above.